

B Series Forged Brass In-Line Spring Loaded 200 WOG Check Valves

700

5.19

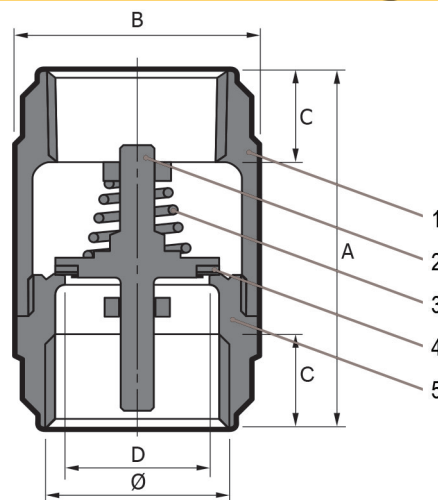
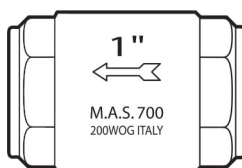

- Forged 2 piece construction
- ANSI B1.20.1 NPT ends
- Center guided piston
- Rubber seated
- 200 WOG

700 PART/MATERIAL		
NO.	PART NAME	MATERIAL
1	Body	Forged Brass ASTM B283-C37700
2	Piston	Thermoplastic Hostaform (POM)
3	Spring	316 Stainless Steel
4	Disc	Rubber – NBR 70SH
5	Cap	Forged Brass ASTM B283-C37700

PRESSURE TEMPERATURE RATING

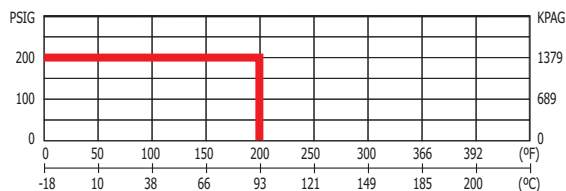

700 DIMENSIONS										
Size	3/8	1/2	3/4	1	1 1/4	1 1/2	2	2 1/2	3	4
A	45	48	53	59	67	70	80	93	102	119
mm/in	1.77	1.89	2.09	2.32	2.64	2.76	3.15	3.66	4.02	4.69
B	27	30	37	45	56	63	79	103	120	155
mm/in	1.06	1.18	1.46	1.77	2.20	2.48	3.11	4.06	4.72	6.10
C	10	11	12	13	14	15	16	18	20	22
mm/in	0.39	0.43	0.47	0.51	0.55	0.59	0.63	0.71	0.79	0.87
D	10	15	20	25	32	40	50	65	80	100
mm/in	0.39	0.59	0.79	0.98	1.26	1.57	1.97	2.56	3.15	3.94
Cv	3.2	4.5	8	12	21	28	47	70	105	185
Weight	0.20	0.25	0.35	0.55	0.80	1.0	1.7	3.5	4.0	7.0
lb/kg	0.09	0.12	0.16	0.25	0.37	0.46	0.78	1.59	1.82	3.2

*NOTES:

- 1) Suitable for domestic applications and horizontal or vertical upward flow installations.
- 2) Not recommended for reciprocating pump applications.
- 3) Contains thermo plastic and rubber components. Confirm suitability with manufacturer on special fluid applications.